

# Connector

## USB Connector Series

### KLS1-148F (USB 3.0 BF DIP TYPE) Series

**Material**

Housing: PBT+30%G/F, Blue  
Terminal: copper alloy(T=0.25mm), Au Plated on contact area;  
Tin Plated on solder area;  
Shell: Brass, Nickel plated

**Electrical Characteristics**

Current Rating: 1.8A for pin 1 & pin 4  
0.25A other contacts  
Contact Resistance: 30m Ohm Max. for pin 1 & pin 4  
50m Ohm Max. for other contacts  
Insulator Resistance: 100M Ohm Min.  
Dielectric Withstanding Voltage: 100 VAC / Minute

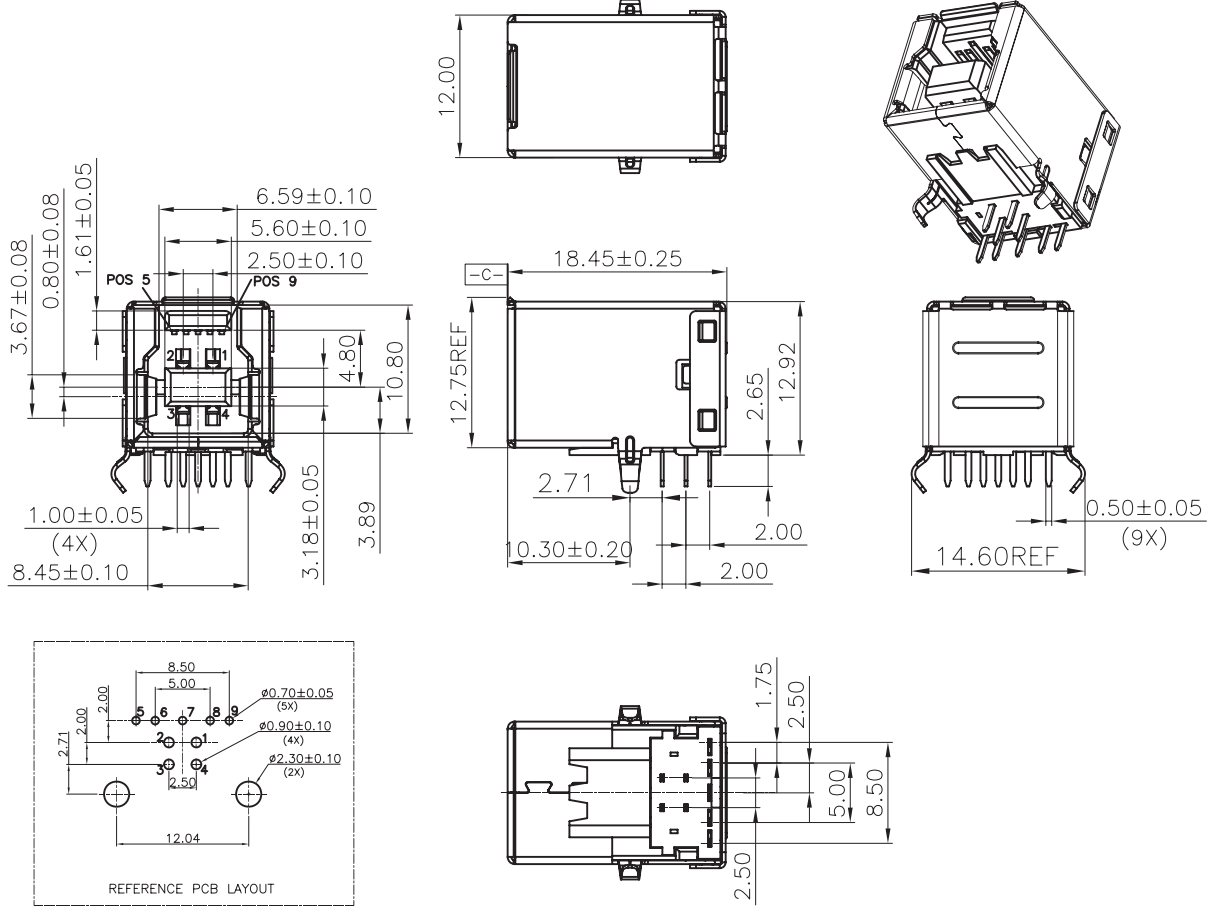
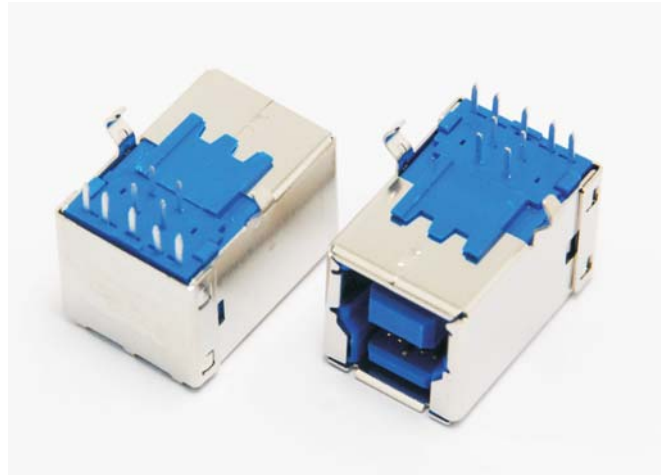

## ORDER INFORMATION

Product NO.: KLS1 - 148F- L

Pos. NO. \_\_\_\_\_ Color: Blue  
USB 3.0 BF DIP TYPE \_\_\_\_\_