

- Notes:
1. Pitch: 10.0mm, Poles: 2~XXP
  2. Rated voltage/current: UL 300V/10A  
VDE 250V/15A
  3. Operation temperatures: -30°C~+120°C
  4. Withstanding Voltage: AC2000V/1Min
  5. Insulation Resistance: 5000MΩ/DC1000V
  6. Wire Range: 22~14AWG, 1.5mm<sup>2</sup> △
  7. Max. Torque Value: M2, 5, 4, 08kgf·cm
  8. Undimensioned Tolerances:

Pitch range in mm	Nominal dimension range			
	over	over	over	over
6 to 10	10	30	60	100
10 to 15	15	24	30	100
15 to 20	20	25	30	100
20 to 25	25	25±0.2	30±0.3	100±0.7
25 to 30	30	30±0.5	30±0.7	100±1.0

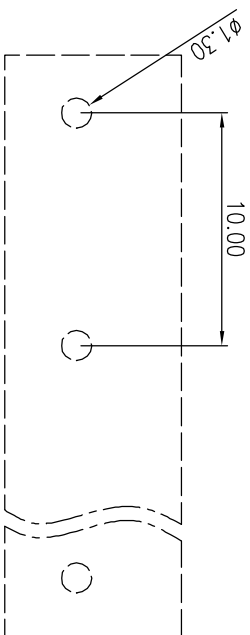

TOP VIEW-LAYOUT

REVISION RECORD				
REV	ECN	DESCRIPTION	DRFT	DATE
△		Drawing Revise	Haoyi	03/17/06
△		增加VDE、CE标志	LJH	12/03/07
△		修改参数	LJH	02/18/09
△	09-0138	修改视图	LJH	11/20/09

ITEM	NAME OF PART	NO. OF PART	Q'TY	MATERIAL	NOTES
4	DG306-pin header	4006B30020 (H)	XX	Brass	SnCe
3	DG301-Screws	S000001420 (H)	XX	Steel	Cr <sup>3+</sup> Zn
2	DG306-spring	X000000160 (H)	XX	Stainless steel	
1	DG306-5.0 Housing	4006A0Y(2XX-1)A (H)	1	PBT	UL94V-0

DETACHED LISTS	
MM	(INCH)
0 ±	±
0.00 ±	±
0.00 ±	±

ANGLES ± 1°

THIRD ANGLE PROJECTION

SCALE : 1:1

NAME: DG306-5.0-XXP-2Y-00A(H)

DRAWING NO. DG306-5.0-E04

/PART NO. A3

DO NOT SCALE DRAWING

SHEET 1 OF 1

DEGSON® 宁波德正电子有限公司	
DEGSON ELECTRONICS CO., LTD	
DFTO Home	DATE 02/09/05
CHD	DATE
MFO	DATE
APPL	DATE

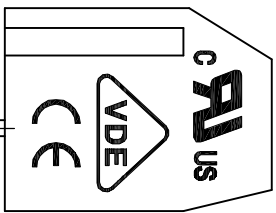
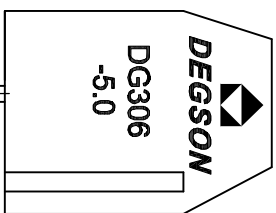
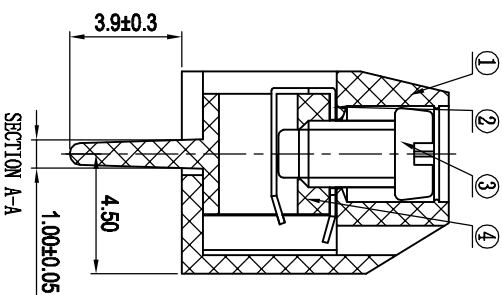
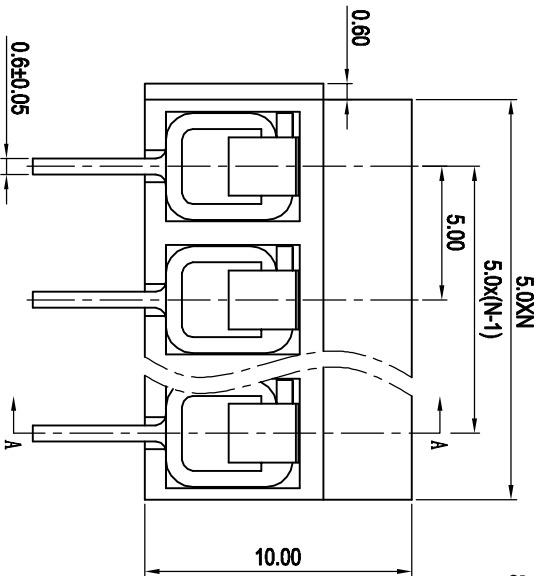
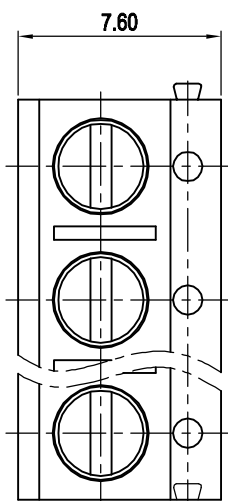

- Notes:
1. Pitch: 5.0mm , Poles: 2-XXP
  2. Rated voltage/current: UL 300V/10A VDE 250V/15A
  3. Operation temperatures: -30°C~+120°C
  4. Withstanding Voltage: AC2000V/1Min
  5. Insulation Resistance: 5000MΩ /DC1000V
  6. Wire Range: 22~14AWG, 1.5mm<sup>2</sup> △
  7. Max. Torque Value: M2.5, 4.08kgf.cm
  8. Undimensioned Tolerances:

Pitch range in mm	Nominal dimension range in mm
over 6 to 10	over 30 to 60
over 10 to 15	over 60 to 100
over 15 to 24	over 100 to 150
over 24 to 30	over 150 to 200
over 30 to 40	over 200 to 250
over 40 to 50	over 250 to 300
over 50 to 60	over 300 to 350
over 60 to 75	over 350 to 400
over 75 to 90	over 400 to 450
over 90 to 110	over 450 to 500
over 110 to 130	over 500 to 550
over 130 to 150	over 550 to 600
over 150 to 180	over 600 to 650
over 180 to 210	over 650 to 700
over 210 to 240	over 700 to 750
over 240 to 270	over 750 to 800
over 270 to 300	over 800 to 850
over 300 to 330	over 850 to 900
over 330 to 360	over 900 to 950
over 360 to 390	over 950 to 1000
over 390 to 420	over 1000 to 1050
over 420 to 450	over 1050 to 1100
over 450 to 480	over 1100 to 1150
over 480 to 510	over 1150 to 1200
over 510 to 540	over 1200 to 1250
over 540 to 570	over 1250 to 1300
over 570 to 600	over 1300 to 1350
over 600 to 630	over 1350 to 1400
over 630 to 660	over 1400 to 1450
over 660 to 690	over 1450 to 1500
over 690 to 720	over 1500 to 1550
over 720 to 750	over 1550 to 1600
over 750 to 780	over 1600 to 1650
over 780 to 810	over 1650 to 1700
over 810 to 840	over 1700 to 1750
over 840 to 870	over 1750 to 1800
over 870 to 900	over 1800 to 1850
over 900 to 930	over 1850 to 1900
over 930 to 960	over 1900 to 1950
over 960 to 990	over 1950 to 2000
over 990 to 1020	over 2000 to 2050
over 1020 to 1050	over 2050 to 2100
over 1050 to 1080	over 2100 to 2150
over 1080 to 1110	over 2150 to 2200
over 1110 to 1140	over 2200 to 2250
over 1140 to 1170	over 2250 to 2300
over 1170 to 1200	over 2300 to 2350
over 1200 to 1230	over 2350 to 2400
over 1230 to 1260	over 2400 to 2450
over 1260 to 1290	over 2450 to 2500
over 1290 to 1320	over 2500 to 2550
over 1320 to 1350	over 2550 to 2600
over 1350 to 1380	over 2600 to 2650
over 1380 to 1410	over 2650 to 2700
over 1410 to 1440	over 2700 to 2750
over 1440 to 1470	over 2750 to 2800
over 1470 to 1500	over 2800 to 2850
over 1500 to 1530	over 2850 to 2900
over 1530 to 1560	over 2900 to 2950
over 1560 to 1590	over 2950 to 3000
over 1590 to 1620	over 3000 to 3050
over 1620 to 1650	over 3050 to 3100
over 1650 to 1680	over 3100 to 3150
over 1680 to 1710	over 3150 to 3200
over 1710 to 1740	over 3200 to 3250
over 1740 to 1770	over 3250 to 3300
over 1770 to 1800	over 3300 to 3350
over 1800 to 1830	over 3350 to 3400
over 1830 to 1860	over 3400 to 3450
over 1860 to 1890	over 3450 to 3500
over 1890 to 1920	over 3500 to 3550
over 1920 to 1950	over 3550 to 3600
over 1950 to 1980	over 3600 to 3650
over 1980 to 2010	over 3650 to 3700
over 2010 to 2040	over 3700 to 3750
over 2040 to 2070	over 3750 to 3800
over 2070 to 2100	over 3800 to 3850
over 2100 to 2130	over 3850 to 3900
over 2130 to 2160	over 3900 to 3950
over 2160 to 2190	over 3950 to 4000
over 2190 to 2220	over 4000 to 4050
over 2220 to 2250	over 4050 to 4100
over 2250 to 2280	over 4100 to 4150
over 2280 to 2310	over 4150 to 4200
over 2310 to 2340	over 4200 to 4250
over 2340 to 2370	over 4250 to 4300
over 2370 to 2400	over 4300 to 4350
over 2400 to 2430	over 4350 to 4400
over 2430 to 2460	over 4400 to 4450
over 2460 to 2490	over 4450 to 4500
over 2490 to 2520	over 4500 to 4550
over 2520 to 2550	over 4550 to 4600
over 2550 to 2580	over 4600 to 4650
over 2580 to 2610	over 4650 to 4700
over 2610 to 2640	over 4700 to 4750
over 2640 to 2670	over 4750 to 4800
over 2670 to 2700	over 4800 to 4850
over 2700 to 2730	over 4850 to 4900
over 2730 to 2760	over 4900 to 4950
over 2760 to 2790	over 4950 to 5000
over 2790 to 2820	over 5000 to 5050
over 2820 to 2850	over 5050 to 5100
over 2850 to 2880	over 5100 to 5150
over 2880 to 2910	over 5150 to 5200
over 2910 to 2940	over 5200 to 5250
over 2940 to 2970	over 5250 to 5300
over 2970 to 3000	over 5300 to 5350
over 3000 to 3030	over 5350 to 5400
over 3030 to 3060	over 5400 to 5450
over 3060 to 3090	over 5450 to 5500
over 3090 to 3120	over 5500 to 5550
over 3120 to 3150	over 5550 to 5600
over 3150 to 3180	over 5600 to 5650
over 3180 to 3210	over 5650 to 5700
over 3210 to 3240	over 5700 to 5750
over 3240 to 3270	over 5750 to 5800
over 3270 to 3300	over 5800 to 5850
over 3300 to 3330	over 5850 to 5900
over 3330 to 3360	over 5900 to 5950
over 3360 to 3390	over 5950 to 6000
over 3390 to 3420	over 6000 to 6050
over 3420 to 3450	over 6050 to 6100
over 3450 to 3480	over 6100 to 6150
over 3480 to 3510	over 6150 to 6200
over 3510 to 3540	over 6200 to 6250
over 3540 to 3570	over 6250 to 6300
over 3570 to 3600	over 6300 to 6350
over 3600 to 3630	over 6350 to 6400
over 3630 to 3660	over 6400 to 6450
over 3660 to 3690	over 6450 to 6500
over 3690 to 3720	over 6500 to 6550
over 3720 to 3750	over 6550 to 6600
over 3750 to 3780	over 6600 to 6650
over 3780 to 3810	over 6650 to 6700
over 3810 to 3840	over 6700 to 6750
over 3840 to 3870	over 6750 to 6800
over 3870 to 3900	over 6800 to 6850
over 3900 to 3930	over 6850 to 6900
over 3930 to 3960	over 6900 to 6950
over 3960 to 3990	over 6950 to 7000
over 3990 to 4020	over 7000 to 7050
over 4020 to 4050	over 7050 to 7100
over 4050 to 4080	over 7100 to 7150
over 4080 to 4110	over 7150 to 7200
over 4110 to 4140	over 7200 to 7250
over 4140 to 4170	over 7250 to 7300
over 4170 to 4200	over 7300 to 7350
over 4200 to 4230	over 7350 to 7400
over 4230 to 4260	over 7400 to 7450
over 4260 to 4290	over 7450 to 7500
over 4290 to 4320	over 7500 to 7550
over 4320 to 4350	over 7550 to 7600
over 4350 to 4380	over 7600 to 7650
over 4380 to 4410	over 7650 to 7700
over 4410 to 4440	over 7700 to 7750
over 4440 to 4470	over 7750 to 7800
over 4470 to 4500	over 7800 to 7850
over 4500 to 4530	over 7850 to 7900
over 4530 to 4560	over 7900 to 7950
over 4560 to 4590	over 7950 to 8000
over 4590 to 4620	over 8000 to 8050
over 4620 to 4650	over 8050 to 8100
over 4650 to 4680	over 8100 to 8150
over 4680 to 4710	over 8150 to 8200
over 4710 to 4740	over 8200 to 8250
over 4740 to 4770	over 8250 to 8300
over 4770 to 4800	over 8300 to 8350
over 4800 to 4830	over 8350 to 8400
over 4830 to 4860	over 8400 to 8450
over 4860 to 4890	over 8450 to 8500
over 4890 to 4920	over 8500 to 8550
over 4920 to 4950	over 8550 to 8600
over 4950 to 4980	over 8600 to 8650
over 4980 to 5010	over 8650 to 8700
over 5010 to 5040	over 8700 to 8750
over 5040 to 5070	over 8750 to 8800
over 5070 to 5100	over 8800 to 8850
over 5100 to 5130	over 8850 to 8900
over 5130 to 5160	over 8900 to 8950
over 5160 to 5190	over 8950 to 9000
over 5190 to 5220	over 9000 to 9050
over 5220 to 5250	over 9050 to 9100
over 5250 to 5280	over 9100 to 9150
over 5280 to 5310	over 9150 to 9200
over 5310 to 5340	over 9200 to 9250
over 5340 to 5370	over 9250 to 9300
over 5370 to 5400	over 9300 to 9350
over 5400 to 5430	over 9350 to 9400
over 5430 to 5460	over 9400 to 9450
over 5460 to 5490	over 9450 to 9500
over 5490 to 5520	over 9500 to 9550
over 5520 to 5550	over 9550 to 9600
over 5550 to 5580	over 9600 to 9650
over 5580 to 5610	over 9650 to 9700
over 5610 to 5640	over 9700 to 9750
over 5640 to 5670	over 9750 to 9800
over 5670 to 5700	over 9800 to 9850
over 5700 to 5730	over 9850 to 9900
over 5730 to 5760	over 9900 to 9950
over 5760 to 5790	over 9950 to 10000
over 5790 to 5820	over 10000 to 10050
over 5820 to 5850	over 10050 to 10100
over 5850 to 5880	over 10100 to 10150
over 5880 to 5910	over 10150 to 10200
over 5910 to 5940	over 10200 to 10250
over 5940 to 5970	over 10250 to 10300
over 5970 to 6000	over 10300 to 10350
over 6000 to 6030	over 10350 to 10400
over 6030 to 6060	over 10400 to 10450
over 6060 to 6090	over 10450 to 10500
over 6090 to 6120	over 10500 to 10550
over 6120 to 6150	over 10550 to 10600
over 6150 to 6180	over 10600 to 10650
over 6180 to 6210	over 10650 to 10700
over 6210 to 6240	over 10700 to 10750
over 6240 to 6270	over 10750 to 10800
over 6270 to 6300	over 10800 to 10850
over 6300 to 6330	over 10850 to 10900
over 6330 to 6360	over 10900 to 10950
over 6360 to 6390	over 10950 to 11000
over 6390 to 6420	over 11000 to 11050
over 6420 to 6450	over 11050 to 11100
over 6450 to 6480	over 11100 to 11150
over 6480 to 6510	over 11150 to 11200
over 6510 to 6540	over 11200 to 11250
over 6540 to 6570	over 11250 to 11300
over 6570 to 6600	over 11300 to 11350
over 6600 to 6630	over 11350 to 11400
over 6630 to 6660	over 11400 to 11450
over 6660 to 6690	over 11450 to 11500
over 6690 to 6720	over 11500 to 11550
over 6720 to 6750	over 11550 to 11600
over 6750 to 6780	over 11600 to 11650
over 6780 to 6810	over 11650 to 11700
over 6810 to 6840	over 11700 to 11750
over 6840 to 6870	over 11750 to 11800
over 6870 to 6900	over 11800 to 11850
over 6900 to 6930	over 11850 to 11900
over 6930 to 6960	over 11900 to 11950
over 6960 to 6990	over 11950 to 12000
over 6990 to 7020	over 12000 to 12050
over 7020 to 7050	over 12050 to 12100
over 7050 to 7080	over 12100 to 12150
over 7080 to 7110	over 12150 to 12200
over 7110 to 7140	over 12200 to 12250
over 7140 to 7170	over 12250 to 12300
over 7170 to 7200	over 12300 to 12350
over 7200 to 7230	over 12350 to 12400
over 7230 to 7260	over 12400 to 12450
over 7260 to 7290	over 12450 to 12500
over 7290 to 7320	over 12500 to 12550
over 7320 to 7350	over 12550 to 12600
over 7350 to 7380	over 12600 to 12650
over 7380 to 7410	over 12650 to 12700
over 7410 to 7440	over 12700 to 12750
over 7440 to 7470	over 12750 to 12800
over 7470 to 7500	over 12800 to 12850
over 7500 to 7530	over 12850 to 12900
over 7530 to 7560	over 12900 to 12950
over 7560 to 7590	over 12950 to 13000
over 7590 to 7620	over 13000 to 13050
over 7620 to 7650	over 13050 to 13100
over 7650 to 7680	over 13100 to 13150
over 7680 to 7710	over 13150 to 13200
over 7710 to 7740	over 13200 to 13250
over 7740 to 7770	over 13250 to 13300
over 7770 to 7800	over 13300 to 13350
over 7800 to 7830	over 13350 to 13400
over 7830 to 7860	over 13400 to 13450
over 7860 to 7890	over 13450 to 13500
over 7890 to 7920	over 13500 to 13550
over 7920 to 7950	over 13550